

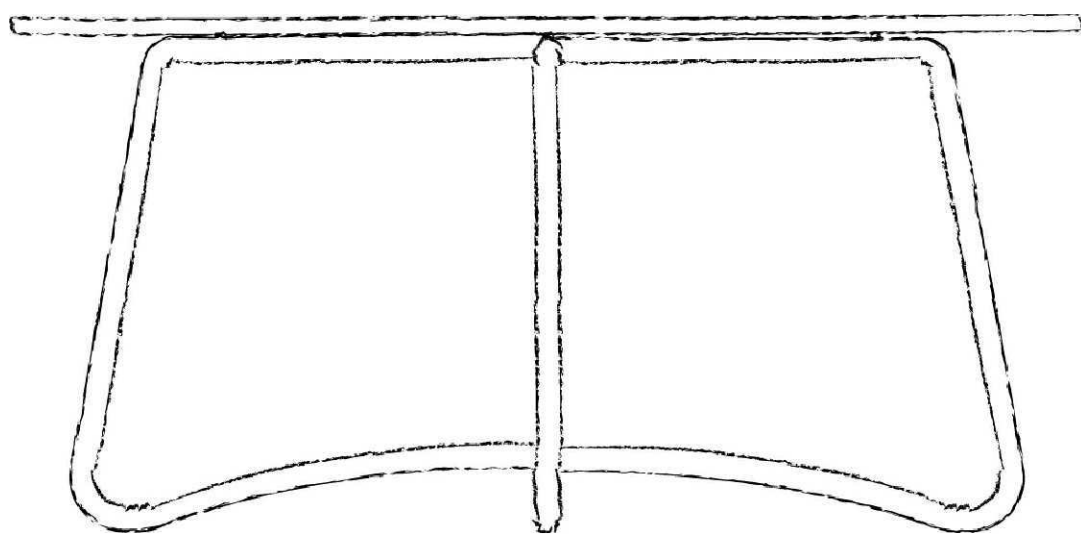

**baxter**

MADE IN ITALY



TAVOLO - RIMINI - TABLE



80 x 80 h 65  
Tavolo / Table

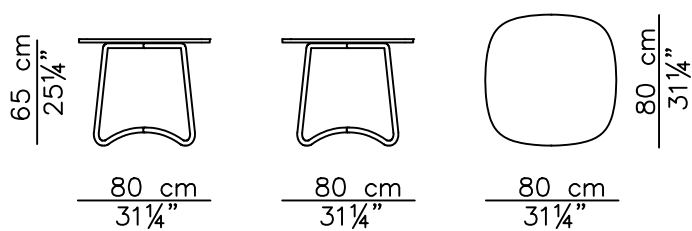

120 x 120 h 65  
Tavolo / Table

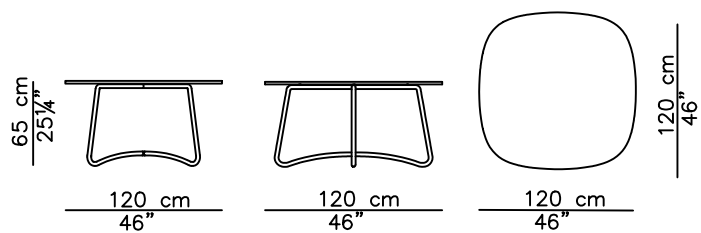

# COMPONENTI

n° 01 - Piano in marmo

n° 04 - Viti 6x45 mm testa cilindrica a brugola

n° 04 - Rondelle  $\phi$  20 mm

n° 01 - Basamento in rame

# COMPONENTS

n° 01 - Marble top

n° 04 - Screws 6x45 mm allen cylindrical head

n° 04 - Washer  $\phi$  20 mm

n° 01 - Copper basament

# 1

Posizionare a terra il basamento. ( *Figura 1* )  
*Put the basement on the floor. ( Picture 1 )*

Fissare il top al basamento. ( *Figura 1* )  
Fix the concrete top to the basement. ( *Picture 1* )

Assemblaggio completato. ( *Figura 2* )  
*The assembly is completed. ( Picture 2 )*

# Figura 1 - Picture 1

Prospetto Frontale / Frontal View

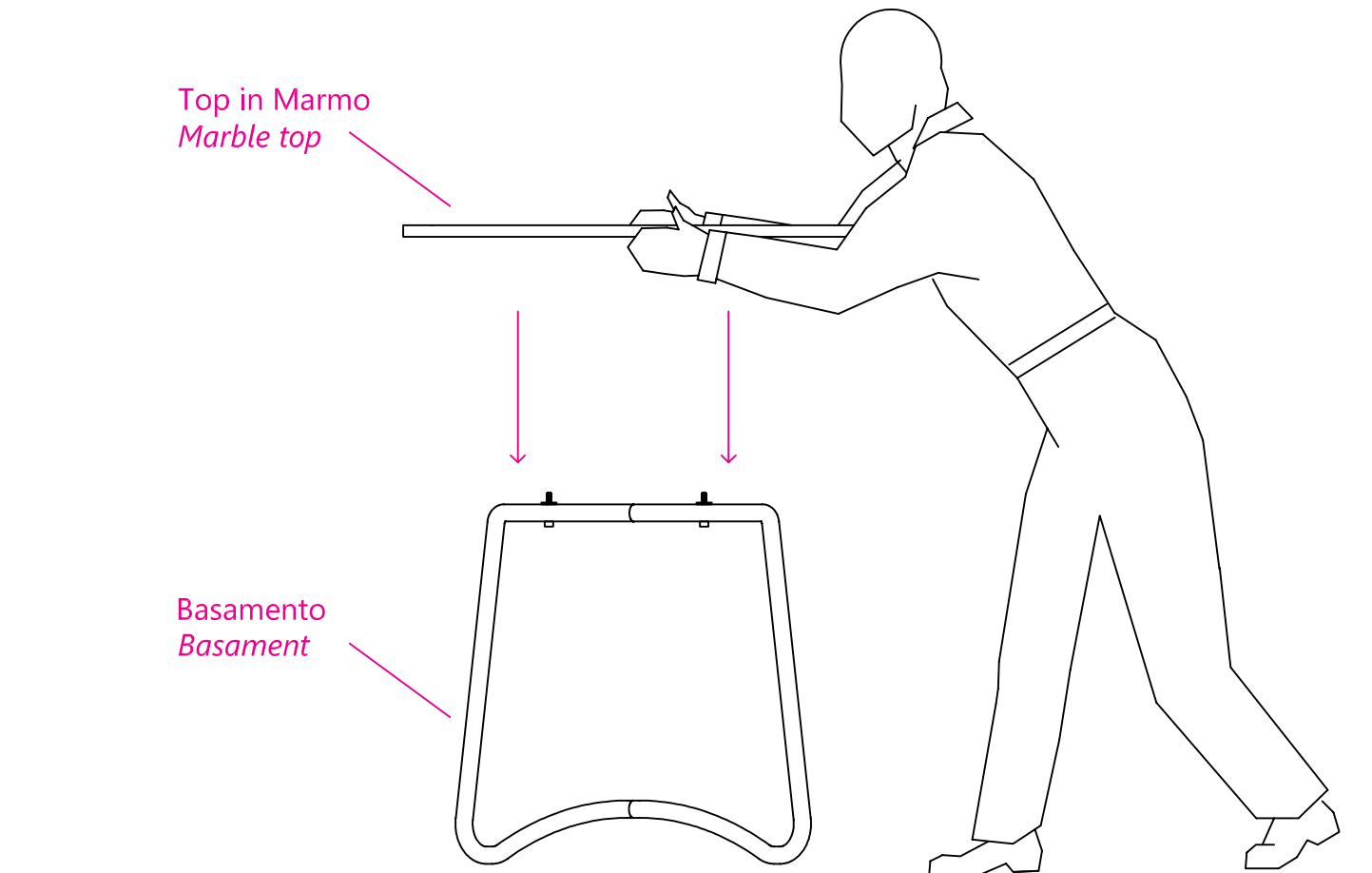
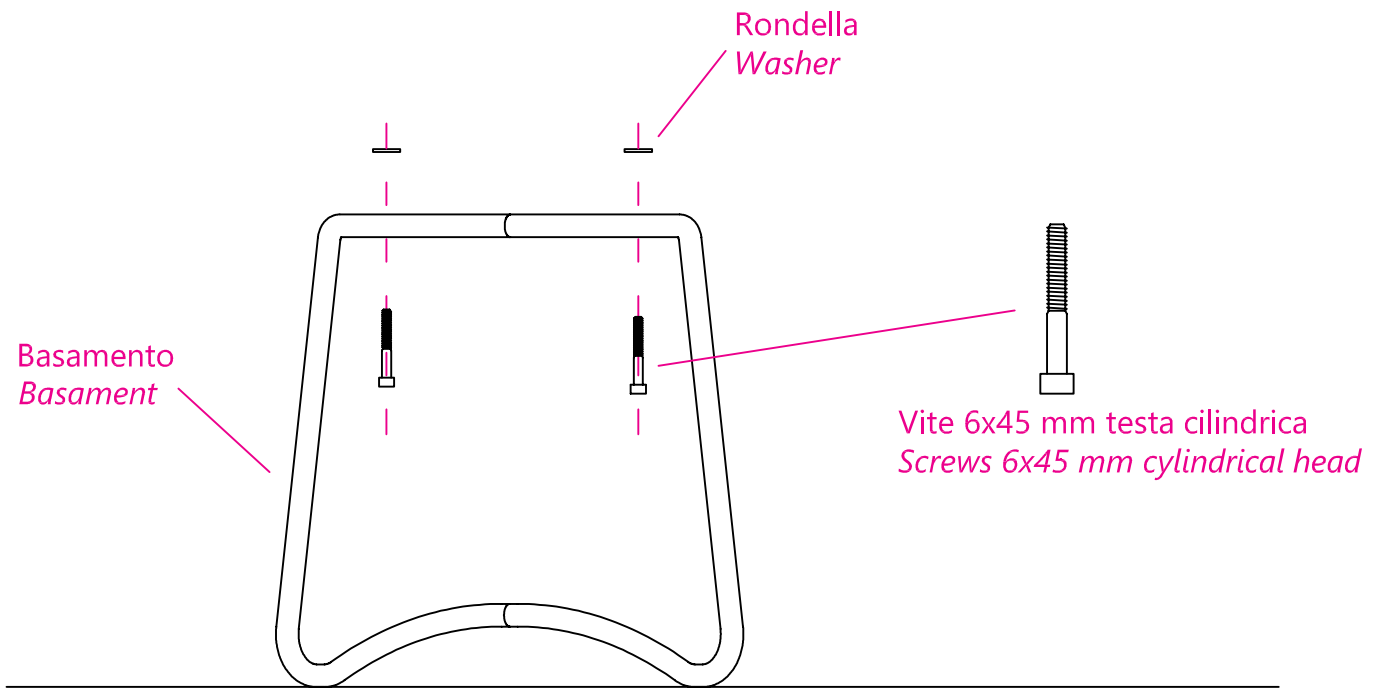

## Figura 2 - Picture 2

Prospetto frontale / Frontal view

